

# Retro Metal Bar Chair

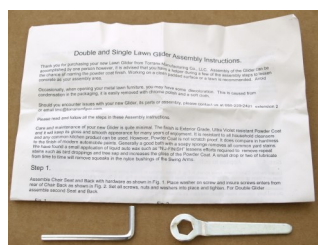

Tools & Instructions



Chair Back



Right & Left Arm

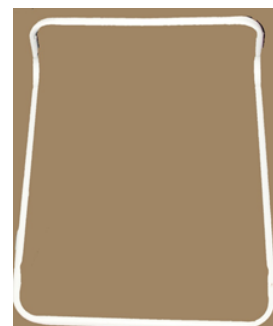

Foot Rest



4 Plastic Spacers



Chair Seat



Cross Member



18 Lock Nuts



36 Washers



4 Short screws for seat/back



4 Medium screws for cross member



4 Long Screws for seat/back to frame

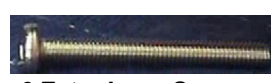

6 Extra Long Screws for foot rest



4 End caps/feet

Working on a clean, padded surface or a lawn is recommended. **Avoid concrete as your assembly area.**

**DO NOT OVER TIGHTEN SCREWS and NUTS! THIS WILL RESULT IN BREAKING THE POWDER-COAT AND WILL VOID YOUR WARRANTY!**

***Occasionally, when opening your metal lawn furniture, you may encounter some slight discoloration. This and many other surface scuff marks can be easily removed or greatly minimized using common Automotive Chrome Polish or "Brasso" brand metal polish and a soft cloth. Use product application directions.***

Care and maintenance of your new chair is quite minimal. The finish is Exterior Grade, Ultra Violet Resistant Powder Coat and will keep its gloss and smooth appearance for many years of enjoyment. Powder Coat finish is resistant to most household cleansers and many common kitchen cleaning products can be used. However, Powder Coat is **NOT** scratch proof. It compares in hardness to modern automobile finishes. Generally a good bath with a soapy sponge removes all common yard stains. We have found a small application of liquid auto wax such as "NU-FINISH" lessens efforts required to remove repeat stains such as bird droppings and tree sap and increases the gloss of the Powder Coat.

Assembly of your Bar Chair will generally be easier if a level, elevated and padded work surface is available. Methods of assembly and use of tools vary by individual through experience and levels of dexterity. These instructions do not contain advised methods of work.

## Step 1.

Assemble Chair Seat and Back with 4 short screws, 8 washers and 4 lock nuts and tools provided. Place 1 washer on each short screw. Place short screw with washer through one of the four Seat and Back mounting holes of Chair Back entering from ***Backside*** of Chair Back. Align matching mounting hole of chair seat over short screw. Place 1 washer on short screw and thread lock nut on hand tight only. After all short screws, washers and lock nuts are installed, tighten all screws and lock nuts being careful not to over tighten. Safely set completed assembly aside.

## Step 2.

Locate ***Left and Right Arms, Foot Rest and 4 End cap/feet***. Fully insert an ***End cap/feet*** into each open end of Left and Right ***Bar Chair Arm***. (See Figure 1) **Take Careful Notice**, each ***Bar Chair Arm*** has slight dimples around mounting holes but are present on one side only. Insure ***Mounting Hole Dimples*** are oriented to ***Outside*** of chair. Locate 6 extra long screws, 12 washers, 6 lock nuts and provided tools.

## Step 2. (continued)

Place 1 **washer** on each **extra long screw**. Match **Foot Rest** mounting holes with matching mounting holes on inside of lower **Arm**. (See Figure 2) **Insure dimples of mounting holes on Arms are facing outward**. Place extra long screw with washer through mounting hole dimple of **Arm** and corresponding **Foot Rest** mounting hole. (See Figure 3) Note screw and washer will seat into dimple of mounting hole. Place 1 washer and 1 lock nut on screw and hand tighten. Repeat for remaining 5 **Foot Rest / Arm** mounting holes.

**Do not tighten.**

## Step 3.

Locate **Cross Member/brace**, 4 medium length screws, 8 washers and 4 lock nuts. Place 1 washer on each screw. Insert screw with washer through dimple on **Arm** at **Cross Member** mounting holes. These mounting holes are closely paired directly under Chair Seat mounting holes. Orient Cross Member towards Chair Seat. (See Figure 4) Place 1 washer and lock nut on screw and hand tighten only. Repeat for remaining 3 cross member/brace.

**Do not tighten.**

## Step 4.

Locate previously assembled Chair seat/back, 4 **Plastic Spacers**, 4 long screws, 8 washers and 4 lock nuts. Place 1 washer on each long screw. Starting at back of Bar Chair, set seat/back into the loosely completed bar chair frame. Ensure front of chair seat rests **on top** of front cross member brace. (See Figure 5) Insert long screw with washer fully through chair arm mounting hole. Place 1 plastic spacer over screw. Ensure curved surface of plastic spacer mates with chair frame. Flat surface of plastic spacer faces Chair seat/back. Carefully guide Chair Back mounting hole over long screw. Repeat process on opposite side. Add 1 washer and lock nut on both screws. Hand tighten only. From front of bar chair, insert long screw with washer through chair frame mounting hole and install **Plastic Spacer** using same alignment method as done previously. (See Figure 6) Carefully align seat mounting hole with screw and fully push screw into dimple of **Arm**. Install 1 washer and lock nut. Repeat on opposite side.

**Tighten ALL Screws and Nuts Beginning With Foot Rest. Tighten Cross Member. Tighten Seat and Back Mounting Screws**

**DO NOT OVER TIGHTEN**

***Your new bar chair is now complete and ready to enjoy!***



FIGURE 1



FIGURE 2



FIGURE 3



FIGURE 4



FIGURE 5



FIGURE 6

